

L
50

SLIDING DOOR SYSTEM



protection against weather conditions

L 50 - SYSTEM FEATURES

- increased safety and comfort of residents,
- reduction of noise coming to the rooms from the outside,
- protection against weather conditions,
- possibility of using various types of infill,
- possibility of constructing multiple door frames,
- possibility of designing and manufacturing glazed sliding segments for balconies and loggias (L 50B) and sliding segments for partition walls (L 50S),
- L 50 system with glazed partition walls is inflammable and has been classified as a fire-retardant structure (NRO),
- possibility of connecting with all YAWAL systems.



See the product on
the website

Picture: Residential building, Kowno
Aluminium manufacturer: UAB „Alseka“

CROSS SECTION THROUGH L 50 SLIDING LEAVES

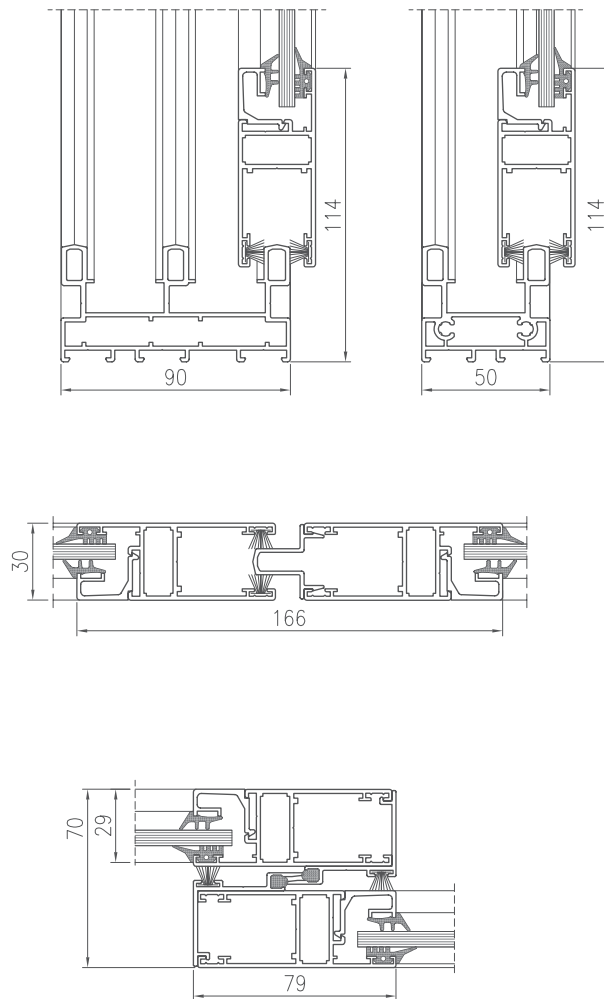

TECHNICAL PARAMETERS – L 50

ENERGY	Thermal insulation EN 10077-2	system without thermal insulation
COMFORT	Acoustic insulation EN ISO 140-3	Rw = 22 dB
SAFETY	Wind load resistance EN 12210	NRO

TECHNICAL PARAMETERS – L 50

Structural depth of a double-track frame	50 mm
Structural depth of a triple-track frame	89,5 mm
Leaf structural depth	30 mm
Infill thickness	4 ÷ 16 mm
Maximum dimensions L x H	window 1300 x 1650 mm door 1300 x 2800 mm
Maximum weight of manual leaf	130 kg
Structure type / leaves diagram	Diagrams: D, F